

### Items provided in kit SK100-WM Security Kit



Security Enclosure Bracket  
Screw/ Washer (B)



*Note: Due to varying wall structures, hardware (screws and anchors) for mounting the wall bracket are not included.*

#### Notes:

1. The security kit instructions are meant for enclosures that are installed on wallmounts.
2. The security kit is to be installed on the back side of the enclosure and can be installed on the right side or the left side. These instructions illustrate the left-side installation.
3. Padlock is not included in SecurityKit.

### Installing Security Bracket to Enclosure

Figure 1

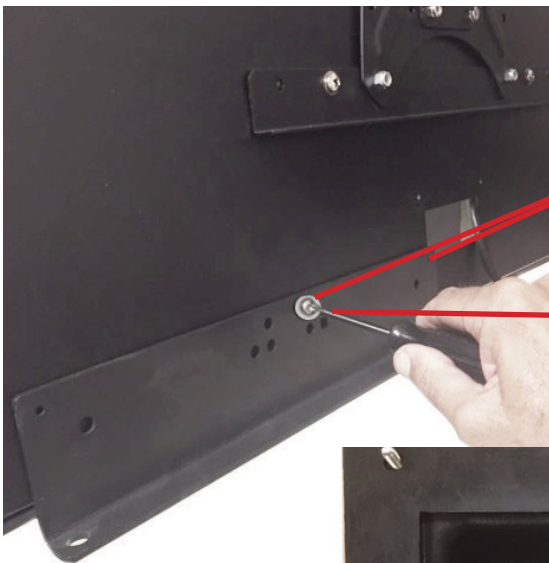

1. Enclosure should be installed on wall mount before starting Security Kit Installation.
2. Remove cable cover (if already attached) from the back of the enclosure and set aside.
3. Align Enclosure Bracket (A) with bottom left attachment hole for cable cover and the corresponding hole in the threaded insert on the back panel of the enclosure (Figure 1).
4. After aligned, fasten the Enclosure Bracket to the back panel with the Stainless-Steel Screw and Washer (B).

Figure 2



5. Trim gasket on Cable Cover by using razor knife or scissors) approximately 1" from the bottom as shown (Figure 2).
6. Be sure to trim the correct side because the Cable Cover will overlap the security Enclosure Bracket (Trim from the right side, for a left-install, and the left side for a right-install.)

Figure 3

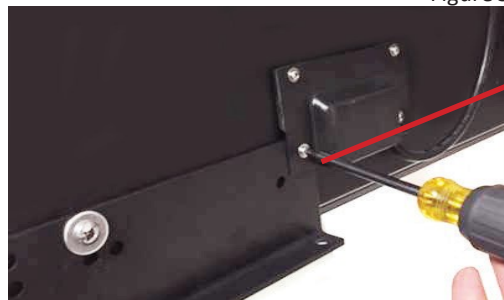

7. Attach the Cable Cover so that it overlaps the Enclosure Bracket and secures the Enclosure Bracket in place (Figure 3).

805-414-5919  
www.apolloenc.com

## Installing Security Wall Bracket

Figure 4



8. Push the Enclosure and Wall Mount as close to the wall as possible.
9. Gently push the bottom of enclosure against wall and mark the location where corner of Enclosure Bracket hits the wall (Figure 4)
10. Position the Wall Bracket (C) in line with marking on wall and mark location for end screw (Figure 5).
11. Using a level, straighten the Wall Bracket, and mark the opposite end hole (Figure 6).
12. To test the placement, temporarily attach bracket to wall using two screws without wall anchors\*.
13. Bring the enclosure toward the wall to see that the Enclosure Bracket and Wall Bracket align properly (Figure 7).
14. If properly aligned, a padlock should easily fit through holes in both brackets (Figure 8).
15. Once alignment is verified, permanently attach bracket to wall using two or three screws and anchors as necessary. \*

Figure 5

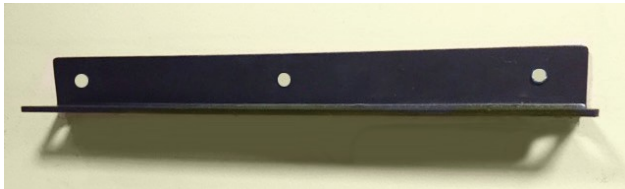
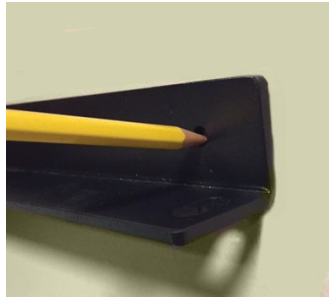

Figure 6



*\* Note: Due to varying wall structures, hardware (screws and anchors) for the mounting the wall bracket are not included.*

Figure 7



Figure 8

